



A co-production with
Cirque-théâtre des bouts du monde
and la TOHU

Beyond The Night Sky

Scenario by Gaël Della Valle, Claudia Gendreau, Andréanne Joubert and Jean-Philippe Joubert

Original idea by Gaël Della Valle and Andréanne Joubert

Written and directed by Jean-Philippe Joubert

Translated by Danielle Le Saux-Farmer

Technical rider – international version **For territories outside of Canada and the USA**

General information

Crew : 4 actors
1 stage manager
1 tour coordinator

Length : 55 minutes

Audience : 5 to 12 years old

Maximum capacity : 350

Stage area

Total width, including wings : 40 feet (12,2 meters)

Width : 24 feet (7,32 meters)

Depth : 20 feet (6 meters)

Ideal height : 19 feet (5,8 meters)

Minimal height : 16,6 feet (5,03 meters)

Stage : flat black floor

Dressing rooms : for 4 actors (2 women, 2 men), with mirrors, showers and toilets

Stage masking : False proscenium arch (*à l'italienne*)

Control booth : Behind the audience

Set description and requirements

There is no setting permanently installed for the show. Every set element moves in and out during the performance.

- A structure of 3 walls fixed together with hinges
- 1 single bed
- 1 table with a reading lamp and a chair
- 1 trampoline, in the shape of a large bed
- 5 chairs

Some elements must be hung on pipes:

- 1 lamp (on which an actress hangs weighing 110 pounds (50 kg))
- 1 Cyr wheel (hung with a double hook)
- 1 skirt shaped like a dome
- 1 piece of fabric hung by 3 electromagnets

A stepladder must be provided in order to hang the piece of fabric at 9 feet high (2,7 meters), preceding every performance.

- 3 wooden pins, each hung by 3 pullies, on which are suspended 3 curtains held together by 3 electromagnets.

Suspended materials are attached to the ground using water bottles to be provided locally or by any other means provided by the presenter

Floor

The presenter provides a dance mat of at least 20' wide and 24' deep. The dance mat must have a matte finish.

We do have a dance floor mat, but we are looking to cut on cargo loading.

Stage masking

The backdrop should open in the center to allow actors to exit the stage.

Four legs stage right, four legs stage left to create 4 exits to each wing.

4 rope lights : 2 hung behind first legs, stage right and left, and 2 hung behind last legs, stage right and left.

Lighting

The presenter must provide 47 spotlights :

17 fresnels 1 KW

4 barn doors lighting (for 1 KW fresnels)

1 19° Leko with a drop-in iris

8 36° Lekos

8 26° Lekos, including 1 with gobo holder

6 Lekos with 6 gobo holders (to illuminate the audience)

3 hung black light fluorescent lights

Nuages en pantalon provides :

- 12 electromagnets grouped in 4 circuits

These pieces of equipment are plugged in the venue's circuits using a north-american electrical outlet adapter (type B).

Our devices use **70** 1,2 Kw dimmers on DMX protocol.
(We can lower that amount, based on theatre's needs.)

The lighting control is operated on a computer equipped with *Light Factory* software program and a USB-DMX Entecc box, all provided by Nuages en pantalon. This system should be compatible with the DMX system in the theater.

The computer also controls a series of equipment devices, based on a second DMX universe :

- 1 Fine Art 2000 motorized base for video projector
- 1 shutter for video projector

as well as other pieces of equipment controlled by wireless DMX :

- 3 LED string lights attached to a Cyr wheel
- 1 LED string lights attached to a skirt
- 5 LED string lights attached to 5 wooden chairs
- 6 LED string lights inserted in 6 juggling sticks
- 1 shutter for video projector
- 13 DMX control boxes (EC-16 Lighting Controllers and Elation DP-415) plugged into 240V to 120V transformers, which in turn are plugged into circuits that are continuously on. The DMX boxes control :
 - 1 suspended lamp
 - 4 rope lights (2 hung behind first legs, stage right and left and 2 hung behind last legs stage right and left.)
 - 7 fans
 - 40 x 40W light bulbs

and :

- 1 Antari X310 smoke machine, plugged in one of the venue's direct circuit using a north-american electrical outlet adapter (type B), located at the back of the scene, and whose DMX signal must be wire-connected.

Sound

The sound control is operated from a Mac Pro on *Live* software program and a Motu UltraLite-mk3 Hybrid sound card. The sound goes out through 8 speakers placed as follows:

- 2 at upstage
- 2 at front stage
- 2 on either side of the audience
- 2 behind the audience
- 2 on stage

The presenter provides those 10 speakers. Except for on-stage speakers, all 8 remaining speakers must be identical.

We own 8 speakers, but we are hoping to cut on cargo loading.

We also provide a wireless microphone:

1 DPA 4061 with a Shure BLX1 transmitter and Shure BLX4R receiver.

Video

The video control is operated from a Mac Pro computer, on *Isadora* software program.

Video output is done with :

- 1 Sanyo XP-56 projector installed on a Fine Art 2000 motorized base
- 1 Sanyo PLC-WTC500AL projector

The presenter provides a riser or a table to place projectors properly. The riser is set at a minimum distance of 36 feet (11 meters) from the scene frame. The surface must be of at least 2 feet x 4 feet (60 cm x 120 cm). The riser's height must allow light rays to be above the audience. The base must be stable.

Control booth

The control booth is preferably set in the audience, at the back.

The control booth must be set less than 26 feet (8 meters) away from video projectors.

A 120V to 240V electrical transformer feeds any piece of equipment that don't tolerate high voltage.

The control booth requires 2 direct electrical circuits, one for computers and other interfaces, one for the video projectors.

Set-up and take down

Depending on the theatre's configuration, set-up will require 8h with a crew of 4 technicians and 1 head technician.

Take down will require 3h with a crew of 4 technicians.

For any question regarding technical specifications :

Jean-Philippe Joubert

Tel. : (418) 997-0790

Email : art@nuagesenpantalon.qc.ca

Setting Beginning of the show

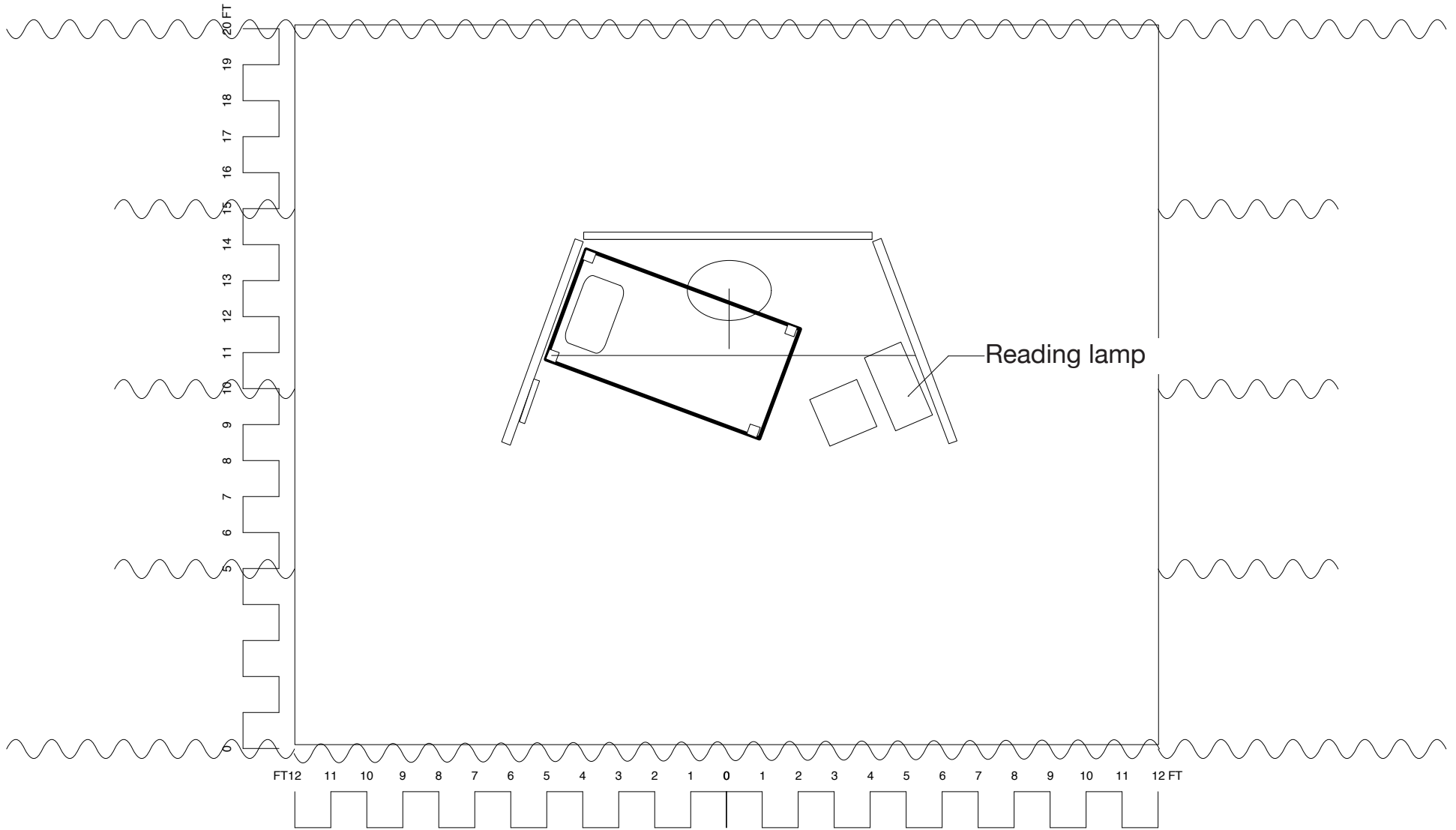

Setting
Beginning of the show
Elevation

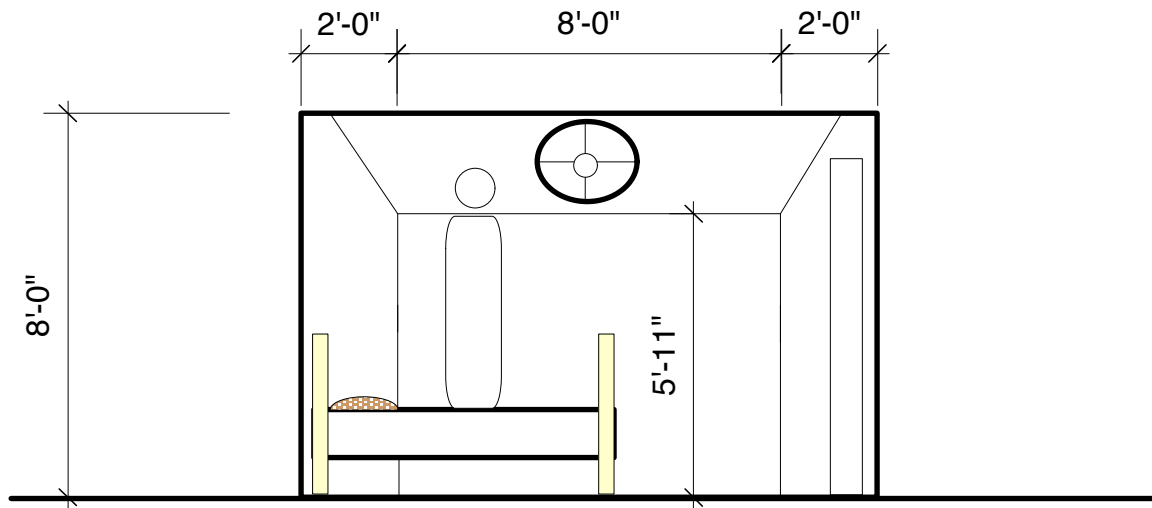

Setting End of the show

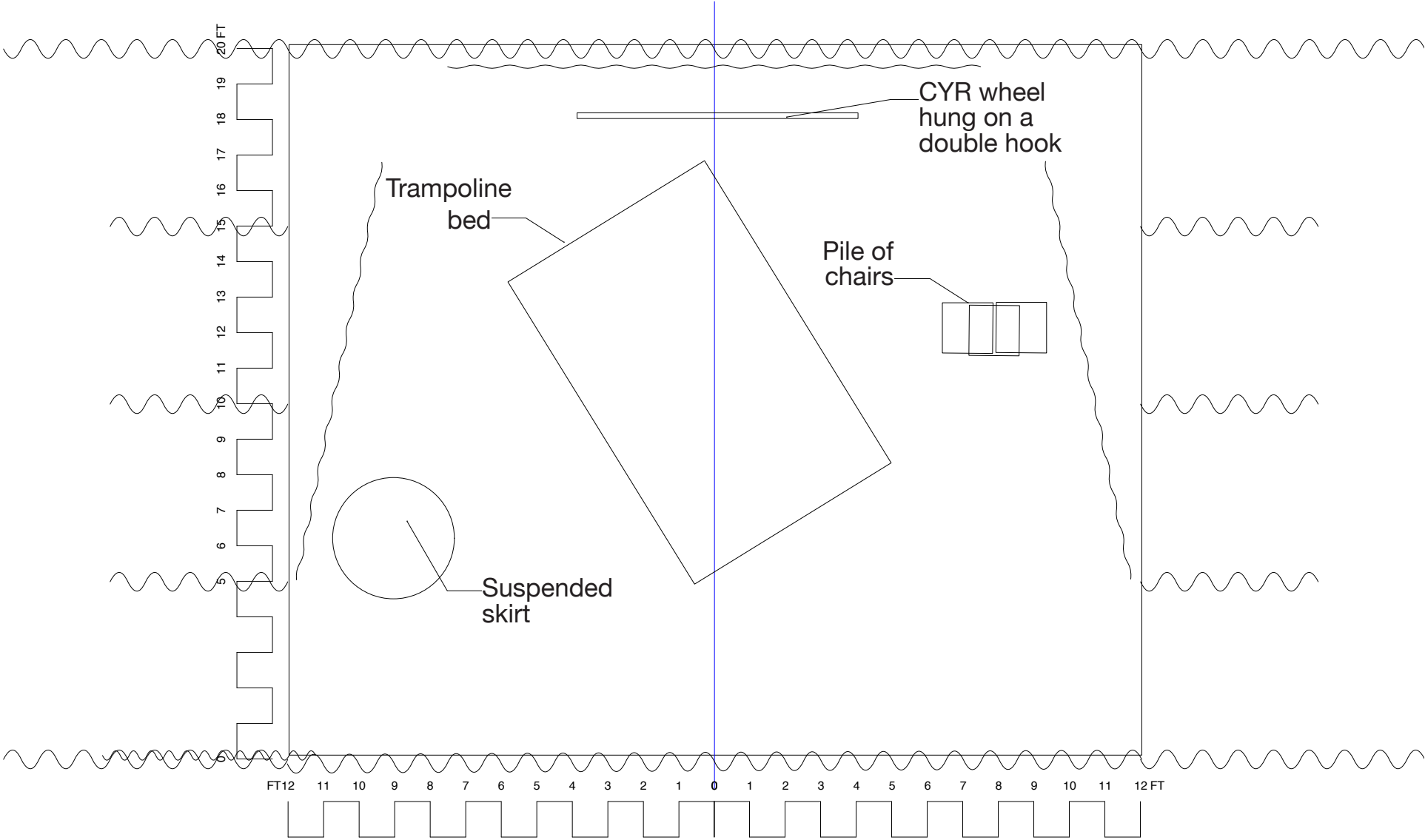

Projectors



Altman 8" Fresnel @ 1kw

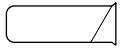

Robert Juliat 614 SX @
1kw/1.2kw



ETC Source-4 19° @ 575w



ETC Source 4 26° @ 575w



ETC Source-4 36° @ 575w

Props



4-Panel Barn Door

Company's props

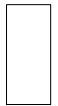

Antari X310



speaker



electro-magnet

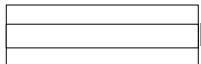

Fluorescent light

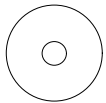

lamp table



rope light



fan



DMX controller

Hooking



water bottle





pulley



hooking point

Color Summary

	<u>Color</u>	<u>Size</u>	<u>Count</u>
	124	7.5"	1
	711?	6.25"	1
	L119	10"	4
	L366	6.25"	8

Ceiling stage

fixed point :
 2 chains + cables
 + hooks for CYR wheel
 (low point : 152" above the ground)

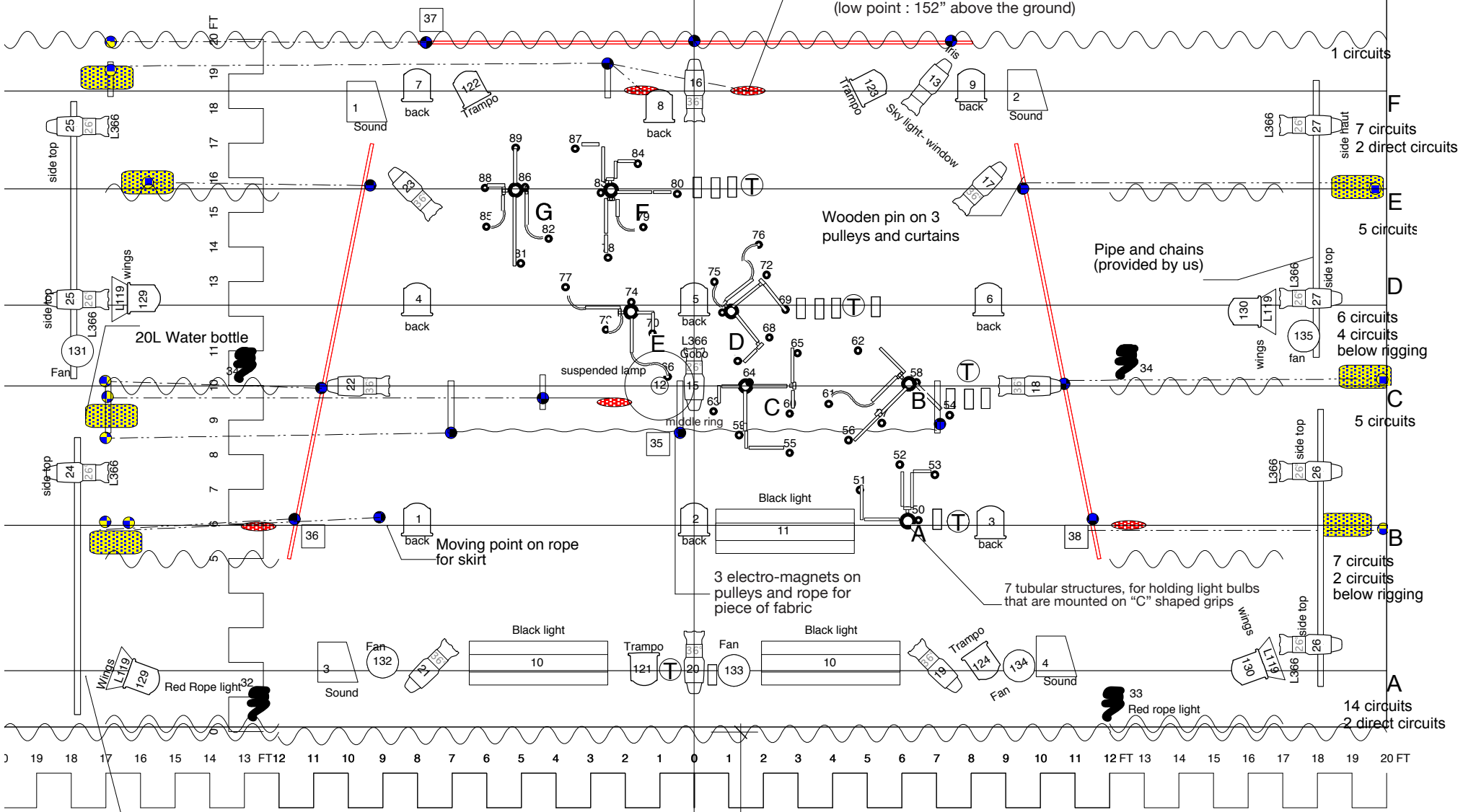

1 circuits

F
 7 circuits
 2 direct circuits

E
 5 circuits

D
 6 circuits
 4 circuits below rigging

C
 5 circuits

B
 7 circuits
 2 circuits below rigging

A
 14 circuits
 2 direct circuits

Wooden pin on 3 pulleys and curtains

Pipe and chains (provided by us)

20L Water bottle

Moving point on rope for skirt

3 electro-magnets on pulleys and rope for piece of fabric

7 tubular structures, for holding light bulbs that are mounted on "C" shaped grips

Pipe and chains (provided by us)
 Provides light between 9'6" and 13' from the ground

Wings

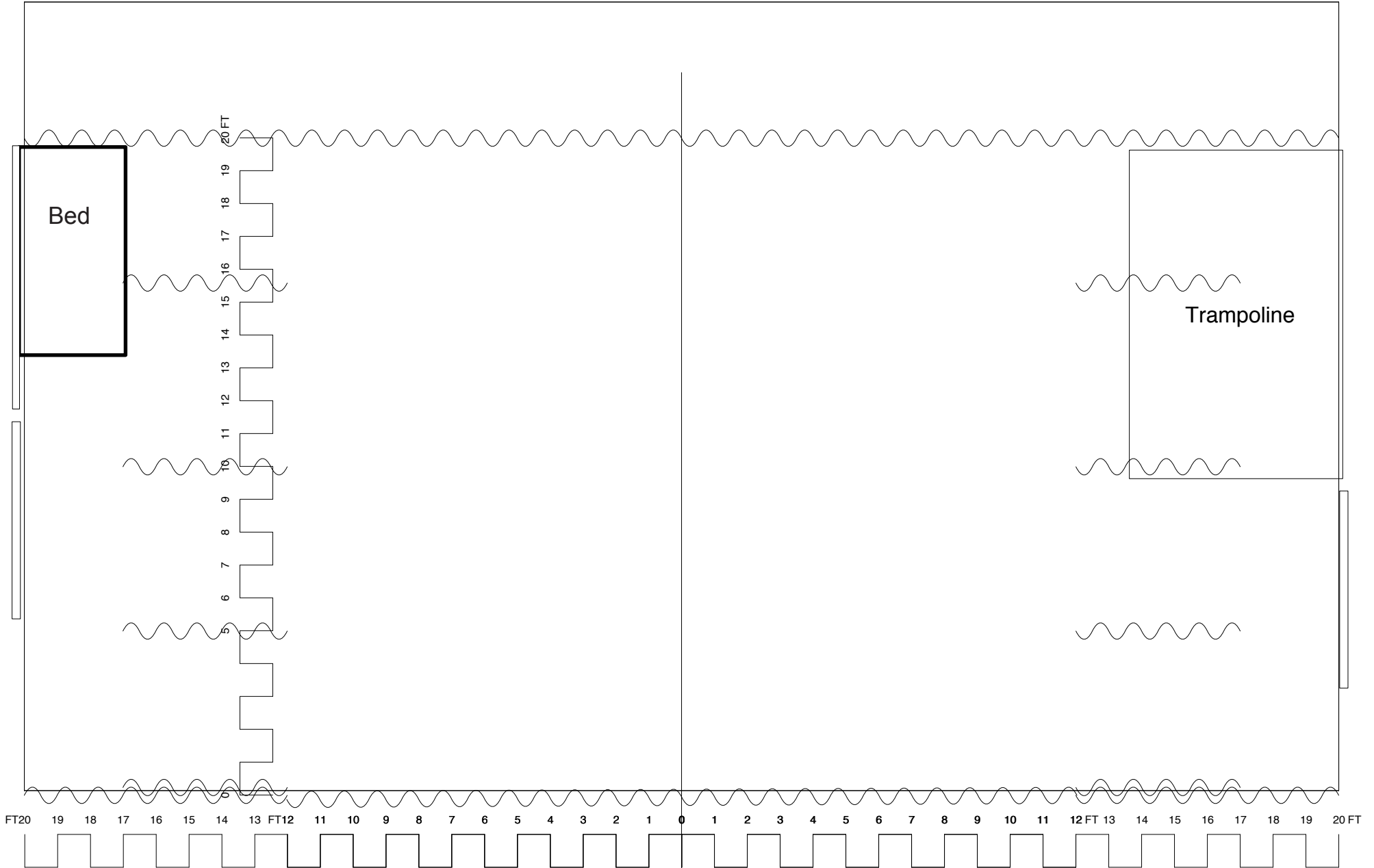

Stage floor

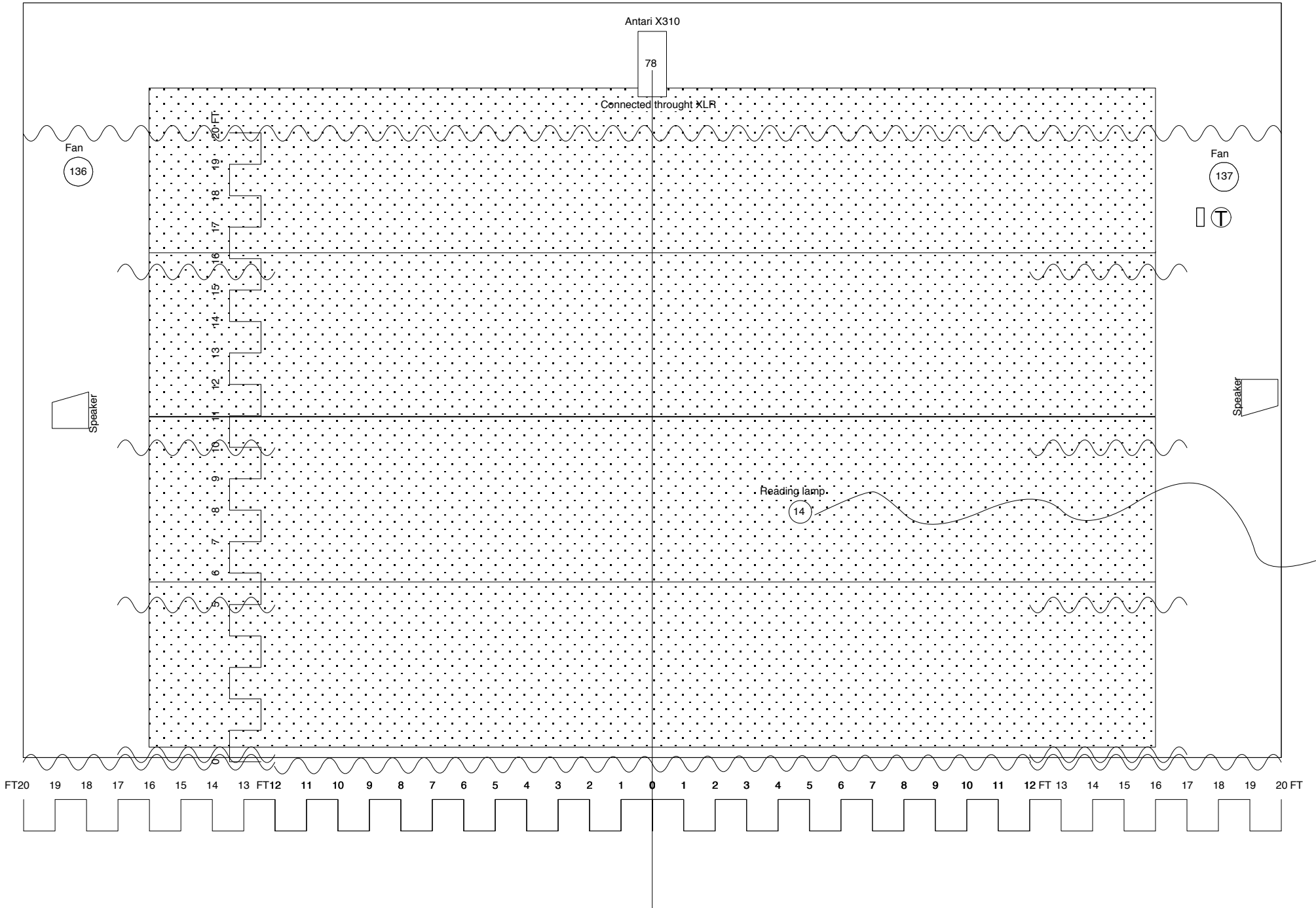

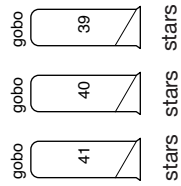

Lights the audience
* Exact positioning to be determined,
based on room specs



speakers on side position

speakers behind the audience

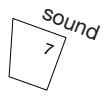

Audience
lighting
&
sound
setup

36'-0"

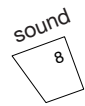
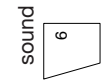
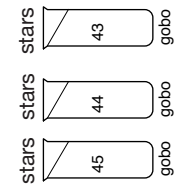

minimum distance : 36'

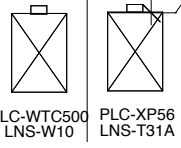

2 direct circuits for control booth

Control booth